



Laboratory infrastructures equipped for scale-up, production, and R&D

A unique campus combining **research laboratories** and **productive activities**

Located within **several innovation research ecosystems in Île-de-France**, just 10 minutes by tram (T12) from Massy and 5 minutes from the École Polytechnique / Marguerite Perey station on Line 18, set to open in 2026.

A top-tier technological infrastructure:

- Fully equipped laboratories (L1/L2), from workbenches to advanced equipment, including fluids for use in biochemistry and chemistry, with backup systems, sprinklers, and 24/7 maintenance.
- Possibility of installing clean rooms.
- A data center in development for storage and computing.
- Offices, meeting rooms, and flexible common areas.
- Laboratory space available starting from 200 m²

An ecosystem to co-build

A unique opportunity to create a dynamic environment bringing together start-ups, scale-ups, CROs, industrial companies, and collaborative projects

Available from autumn 2025

KEY FIGURES

16 ha	plot
32 000 sqm	labs available & fully equipped labs
60 000 sqm	green light industrial park
3 000 sqm	of which retail
3 500 sqm	food hall, event area, coworking (existing building)
1 000 sqm	pépinière d'entreprise

Excellent connections with Paris, Orly Airport, and the highway



T12 Station Chilly-Mazarin and Longjumeau in 3 minutes on foot
Train Station **Massy Palaiseau** in 7 min



Paris Gare de Lyon in 35 min



A6 in 3 min

A126 in 7 min



Orly airport in 12 min

Metro connection between



in 2026

The size of the BOOST Campus allows

- Aggregating critical infrastructures
- Ensuring proprietary and secure computing and storage capacities thanks to the 50 MW available

BOOST CAMPUS at the heart of different ecosystems

- **Proximity to the Paris-Saclay cluster**, a major European center for research, innovation, and technology
- **Key sectors:** Biotechnology, health, artificial intelligence, defense, cybersecurity
- **Collaboration opportunities** facilitated between businesses, researchers, and institutions.
- **An environment conducive to innovation**

Tissu économique

- Concentration des emplois liés à la cybersécurité
- Autre localisation préférentielle des entreprises de la cybersécurité

Principaux acteurs de la cybersécurité

- Structure étatique
- Structure de recherche
- Structure de formation
- Santé

Fond de plan

- Espace urbain
- Espace boisé
- Réseau routier principal
- Hydrographie principale

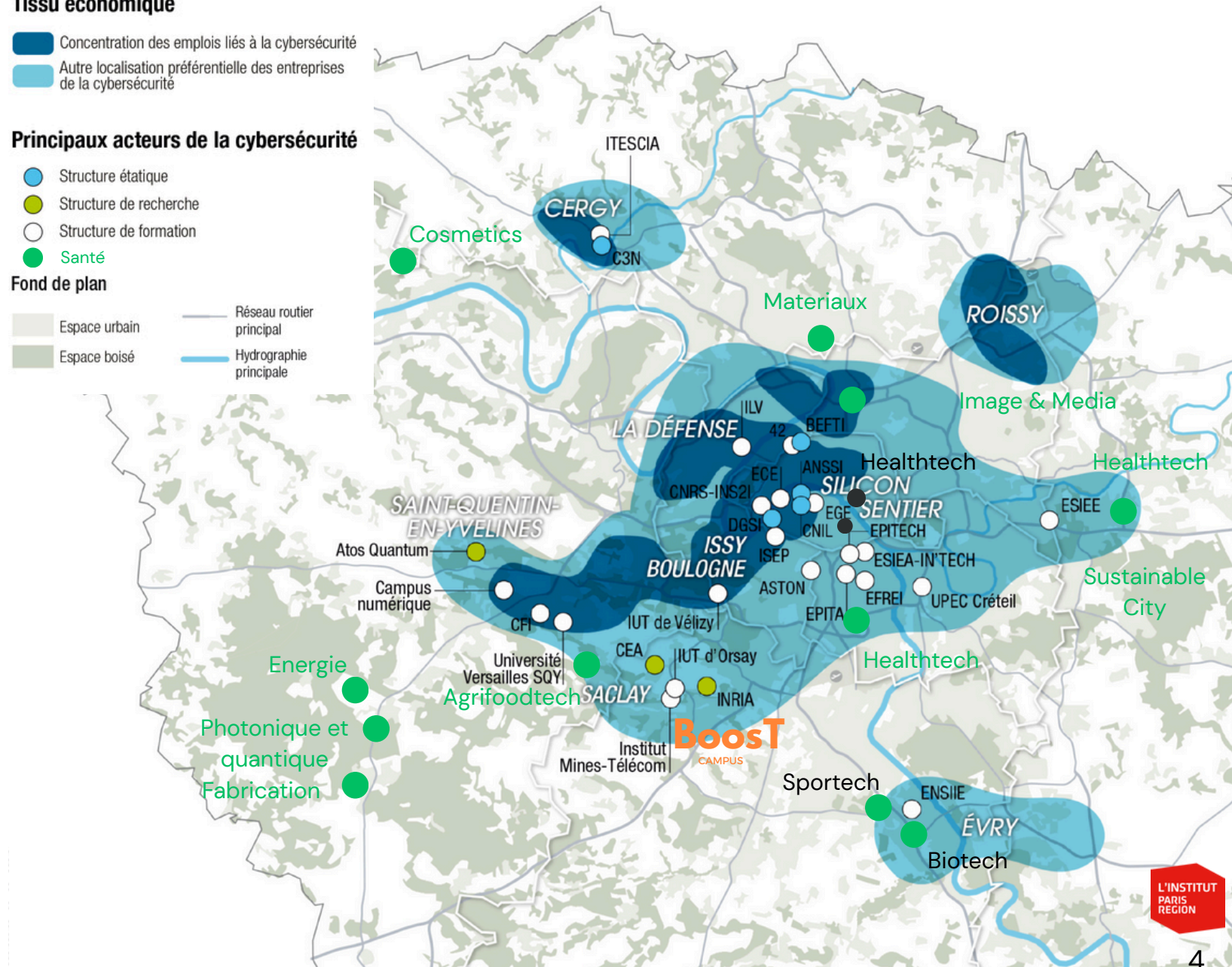

BOOST CAMPUS, a rich environment for collaborations

RESEARCH CENTERS & INSTITUTIONS



INCUBATEURS & START-UPS



HEIGHER EDUCATION



ECONOMICAL ACTIVITY



Two dynamics that coexist

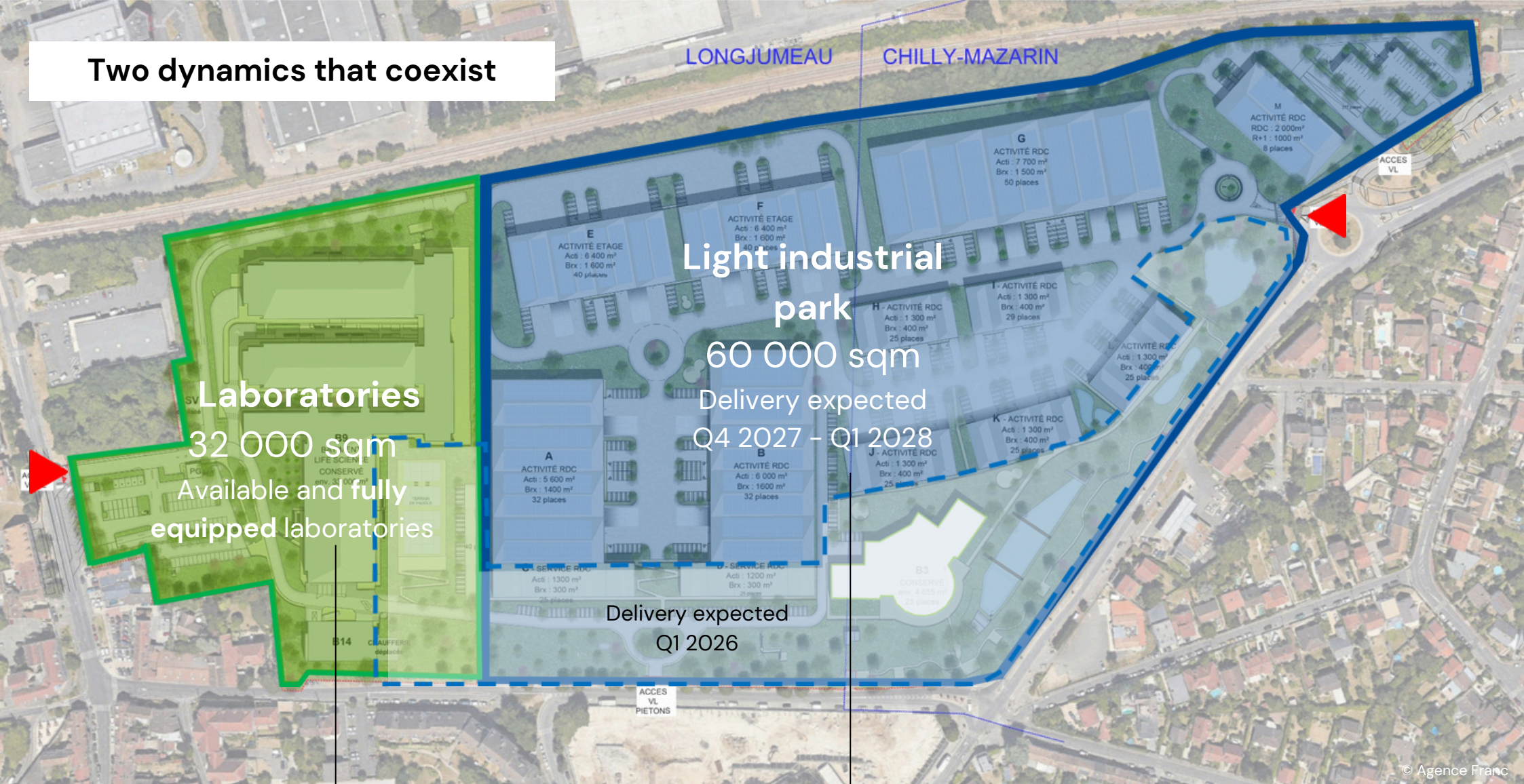

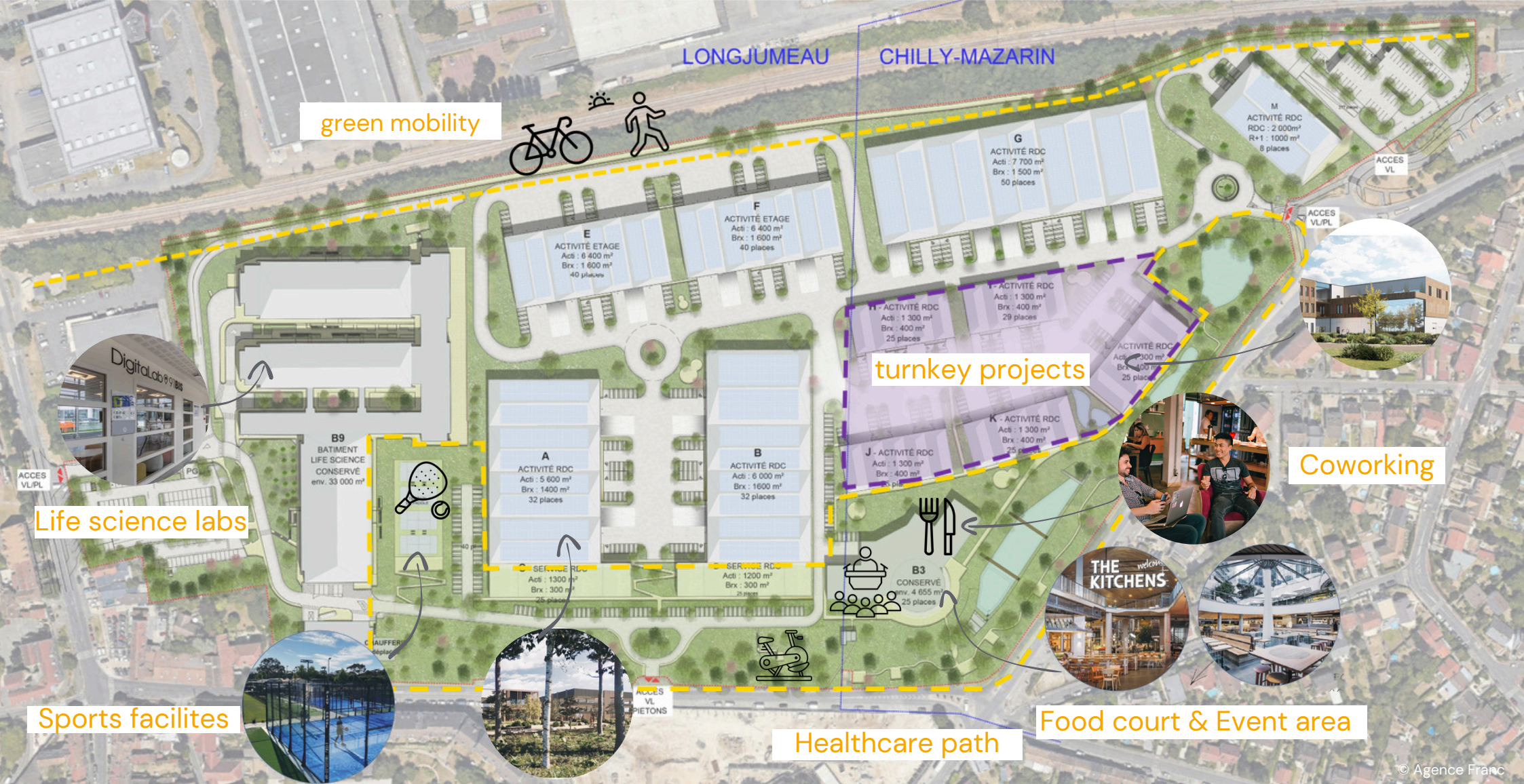

A project open to both cities

An architecture on a city scale that promotes economic activity, leisure, green spaces, and public areas

- Existing and fully equipped laboratories
- Buildings dedicated to productive activities, with supporting spaces (offices, storage, etc.) and the possibility of turnkey projects
- Services for employees: food hall, event space, coworking (existing building)

Laboratoires

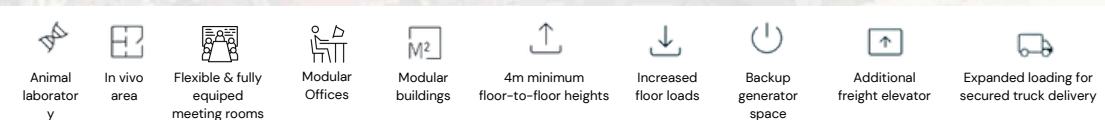
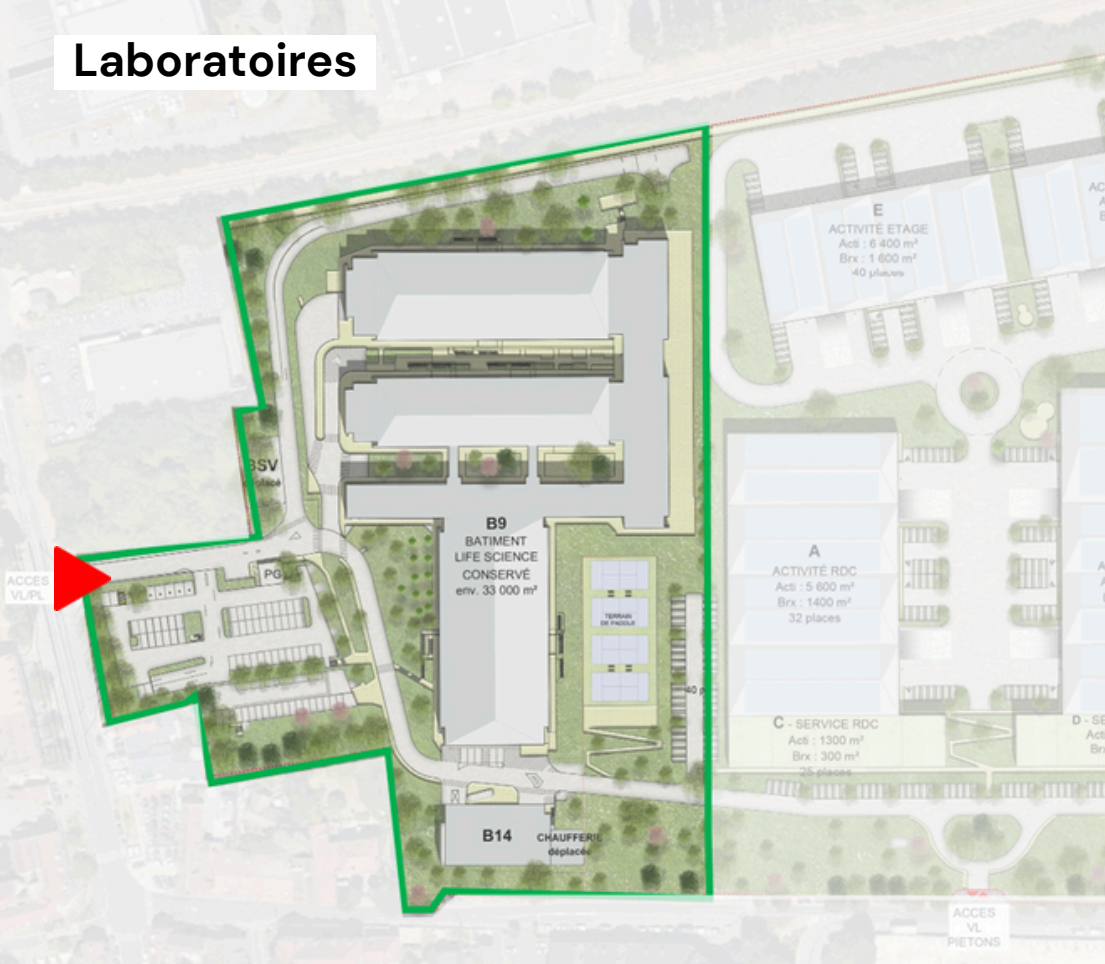

32 000 sqm

Laboratories available and fully equipped, divisible from 190 m² and accessible via a private entrance

Three Story Building

- Chemistry
- Biochemistry
- Pharmacology
- Animal Facility
- Offices and meeting rooms

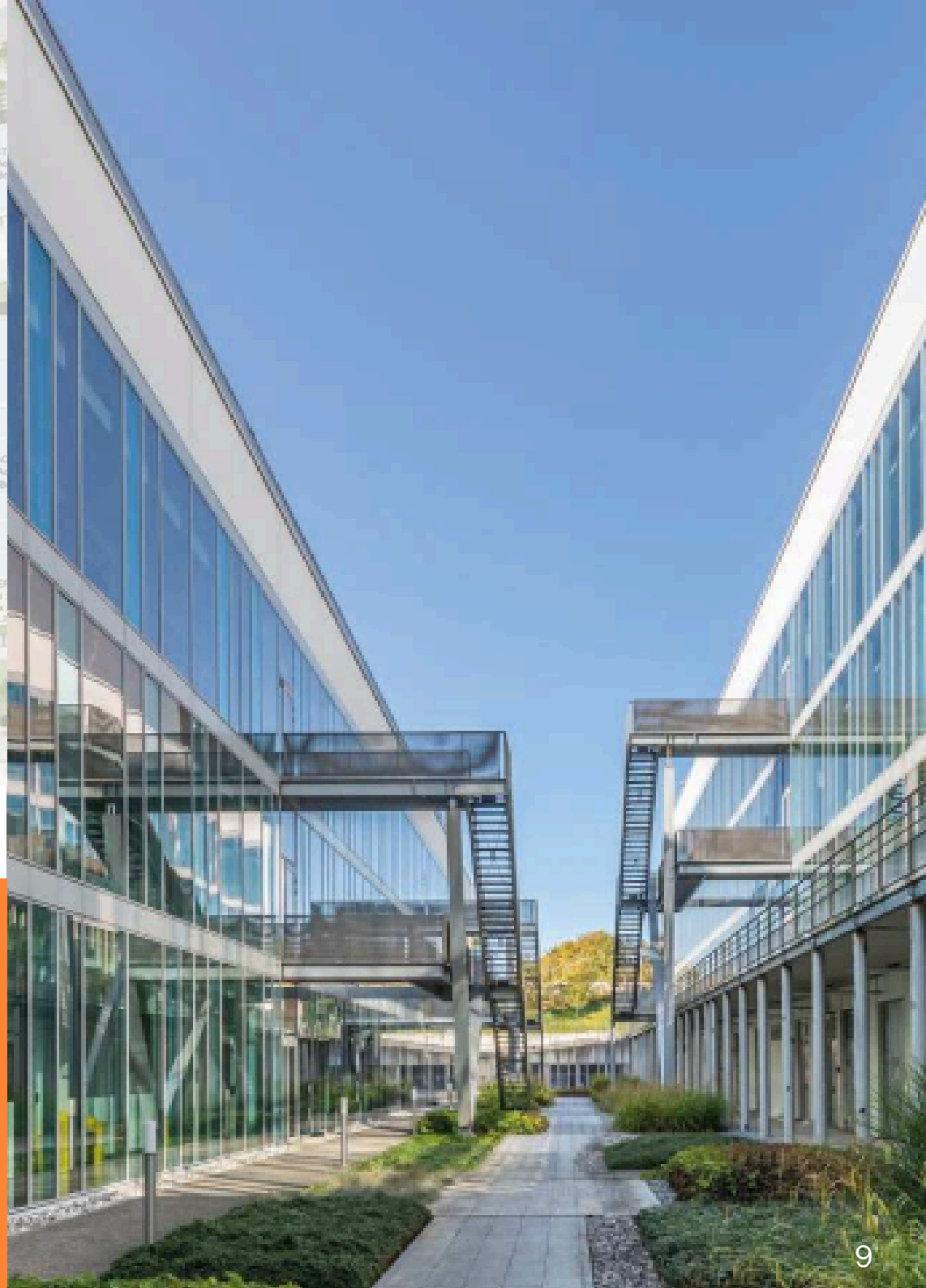

Laboratoires



Buildings delivered in 2014
SLA Architects and Jacobs Engineering

- Pharmacology
- Biochemistry
- Chemistry
- Offices & meeting rooms

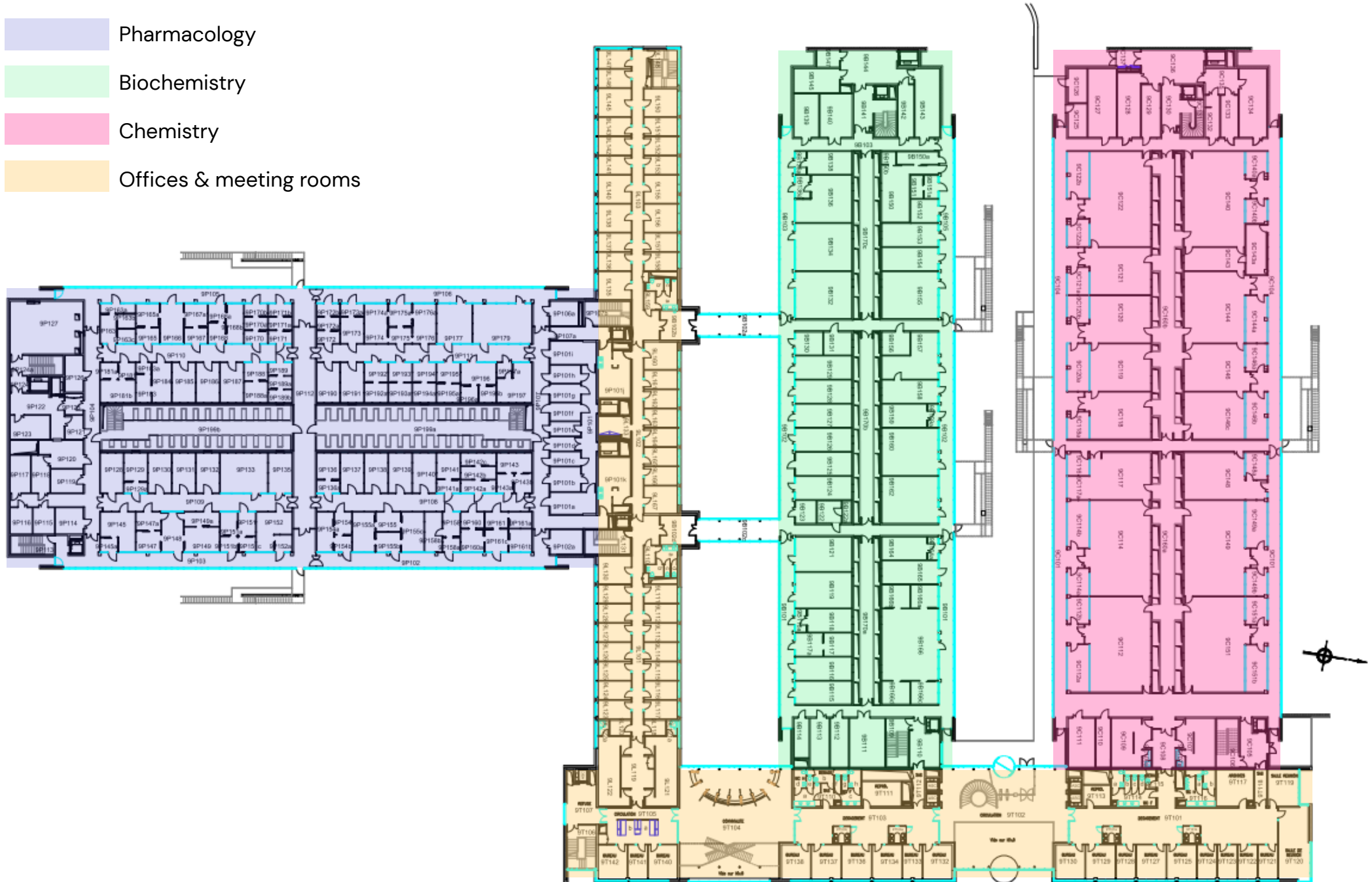

Chemistry laboratories

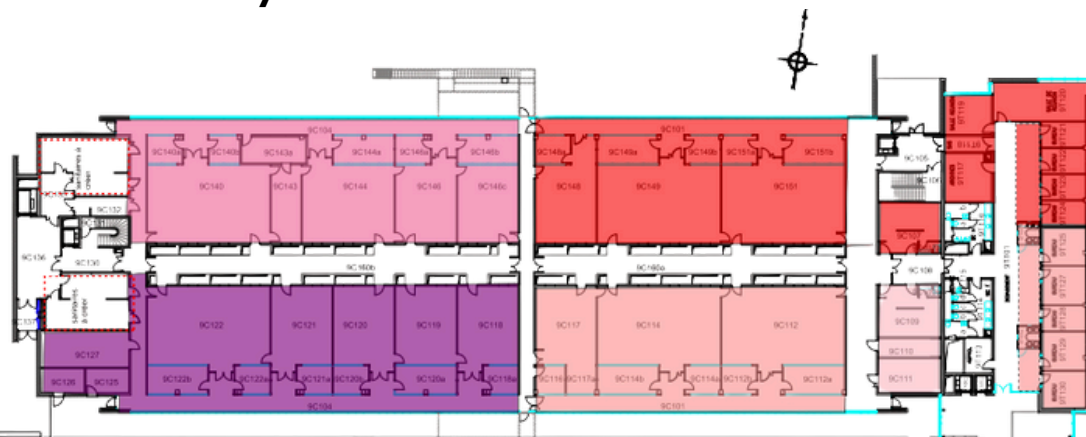

2,700 sqm per level

4 identical modules of 365 sqm per floor: 1 hydrogenation and carbonylation laboratory, 1 chemical products room, 1 synthetic intermediates room, 1 shared laundry

Each chemistry module is designed for 6 workstations, i.e., 3 people per half-module. The equipment is as follows:

- 6 Secuflow-type fume hoods with sprinkler systems
- 4 work hoods (2000 mm)
- 2 work hoods (1500 mm)
- 1 microwave hood
- 1 Camag hood including an internal spray cabin
- 1 fume hood dedicated to unattended operations during nights and weekends, protected by a Firetrace system with an extinguishing agent cylinder located in the technical gallery

Technical Specifications	Chemistry Laboratory
Floor load capacity	350 kg/m ²
HSP, Clear ceiling height	2.80 m
Air renewal	
Floor and ceiling finish	Flexible flooring
Fire safety	Sprinkler system
Type of laboratory benches	
Backup generator	
Available fluids	<ul style="list-style-type: none"> • Deionized/softened water • Vacuum (1 and 10 mbar), dry • Compressed air (7 bar) • Nitrogen (7 bar) • Argon • Glycol water -18°C • CO₂
Possibility to add additional fluids	yes
Possibility to add furniture	yes
Flexibility/adaptability	yes



Biochemistry laboratories



biochimie : 2 040 sqm per level
6 identical modules of 190 sqm per level

Indoor climate conditions

T °C	HR %	Airborne particulate concentration	Pressure
<ul style="list-style-type: none">• T°max=25°C• T°min=20°C• T°max=25°C• T°min=20°C	40<HR<70	<ul style="list-style-type: none">• NC• Iso 8	<ul style="list-style-type: none">• -15 Pa• Légère slight overpressure

Technical Specifications	Chemistry Laboratory
Floor load capacity	450 kg/m²
HSP, Clear ceiling height	2.80 m
Air renewal	
Floor and ceiling finish	Flexible flooring
Fire safety	Sprinkler system
Type of laboratory benches	
Backup generator	
Available fluids	<ul style="list-style-type: none">• Deionized/softened water• Vacuum (1 and 10 mbar), dry• Compressed air (7 bar)• Nitrogen (7 bar)• Glycol water -18°C• CO₂
Possibility to add additional fluids	
Possibility to add furniture	
Flexibility/adaptability	

Biochemistry laboratories



Pharmacology laboratories

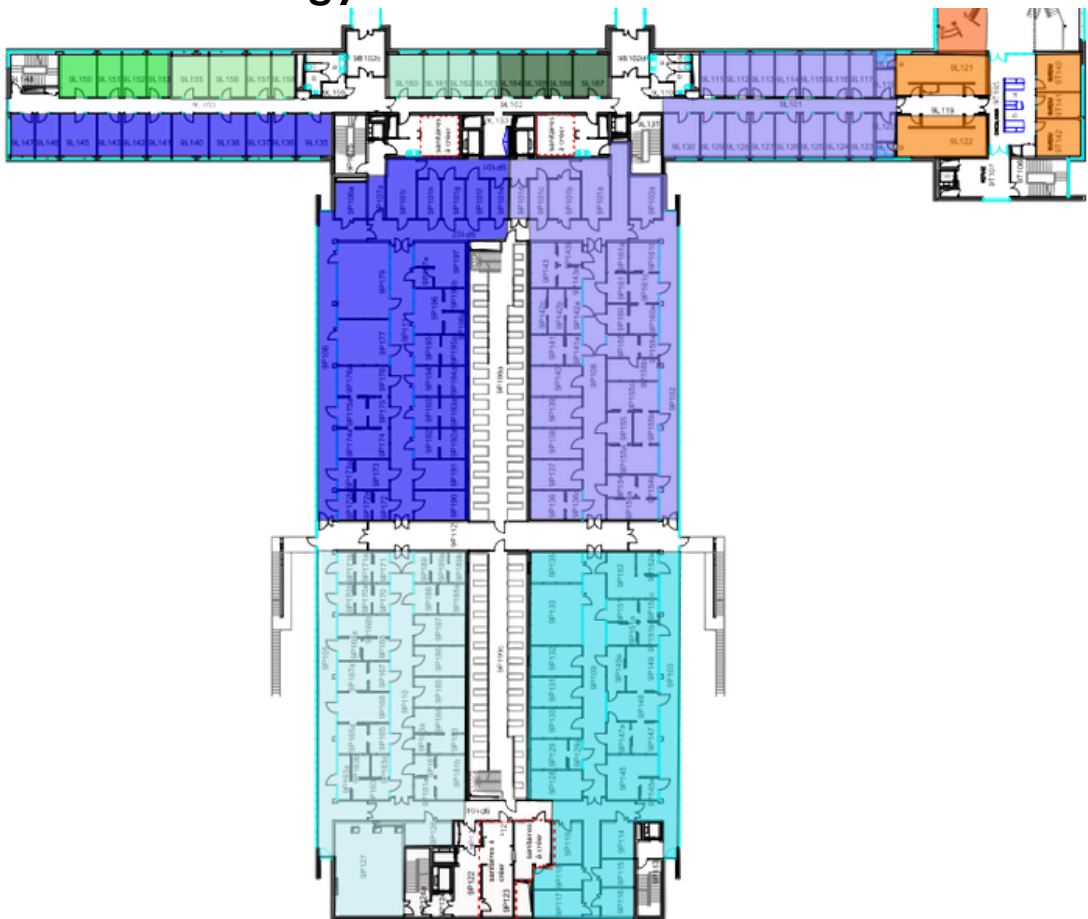

Pharmacology : 2,850 sqm per floor

6 identical modules of 335 sqm per level

Indoor climatic conditions

T °C	HR %	Dusting process	Pressure
22+/-2°C	45/65	Iso 8	-30/+30

Technical Specifications	Chemistry Laboratory
Floor load capacity	350 kg/m²
HSP, Clear ceiling height	2.80 m
Air renewal	
Floor and ceiling finish	Flexible flooring
Fire safety	Sprinkler system
Type of laboratory benches	
Backup generator	
Available fluids	<ul style="list-style-type: none">• Deionized/softened water• Vacuum (1 and 10 mbar), dry• Compressed air (7 bar)• Nitrogen (7 bar)• Argon• Glycol water -18°C• CO₂
Possibility to add additional fluids	
Possibility to add furniture	

Pharmacology laboratories

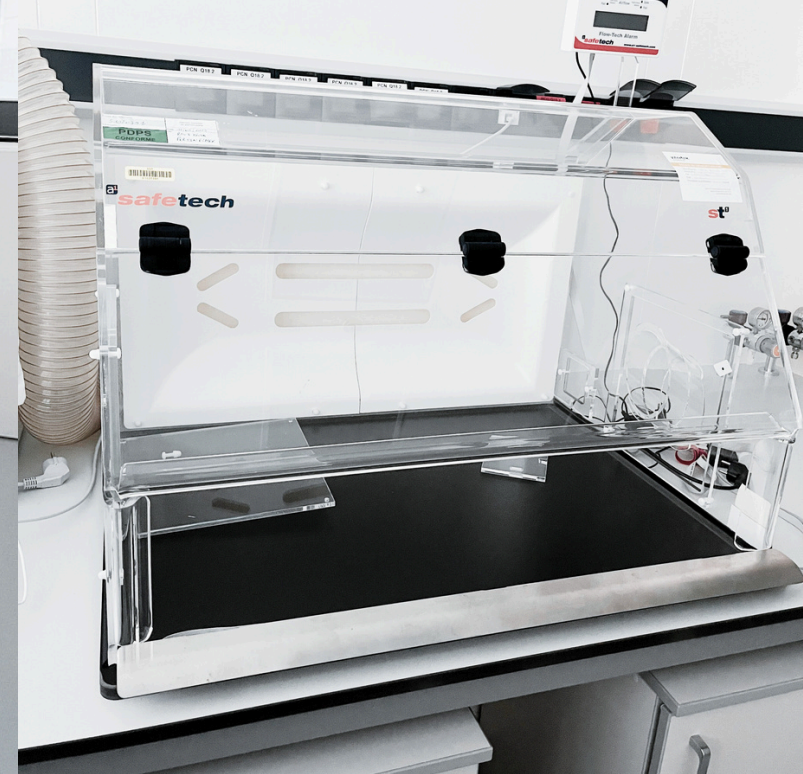

Technical galleries and technical room



Common areas



Services

Building B9

R-1

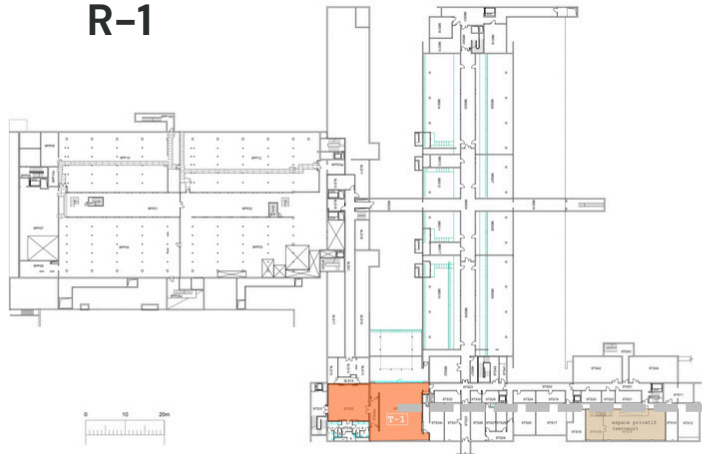

Meeting rooms

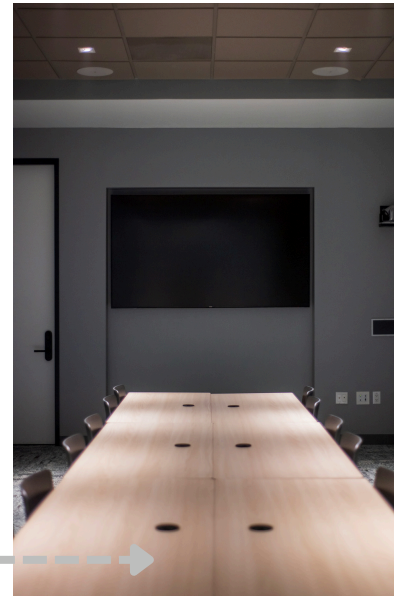

Ground-floor

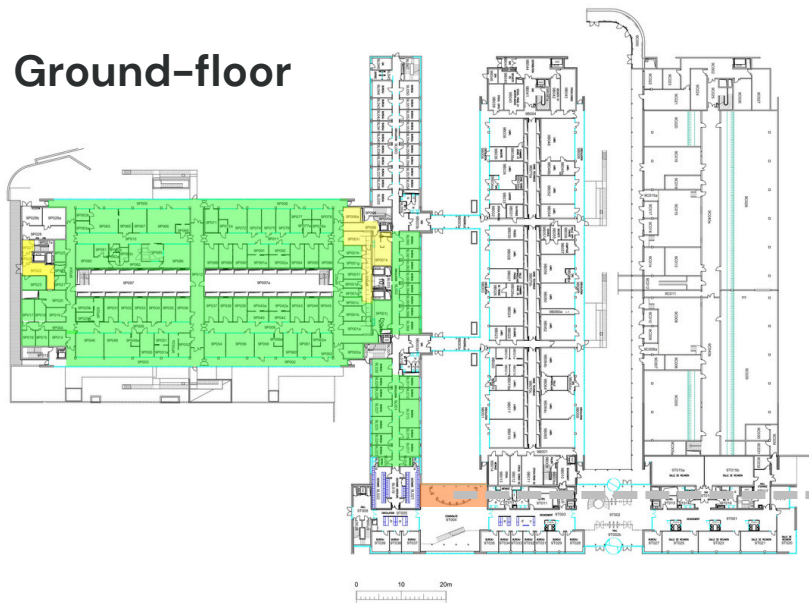

Espace café/ tisanerie



Services

Building B3

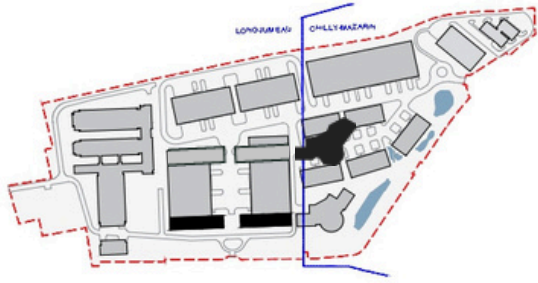

**Renovated
building, open to
the public**

The former restaurant will be completely renovated, giving rise to a building that is open to the city and offers a rich and diverse range of spaces:

- a food hall and an event space open to the public
- an incubator area
- office spaces
- industrial workshops

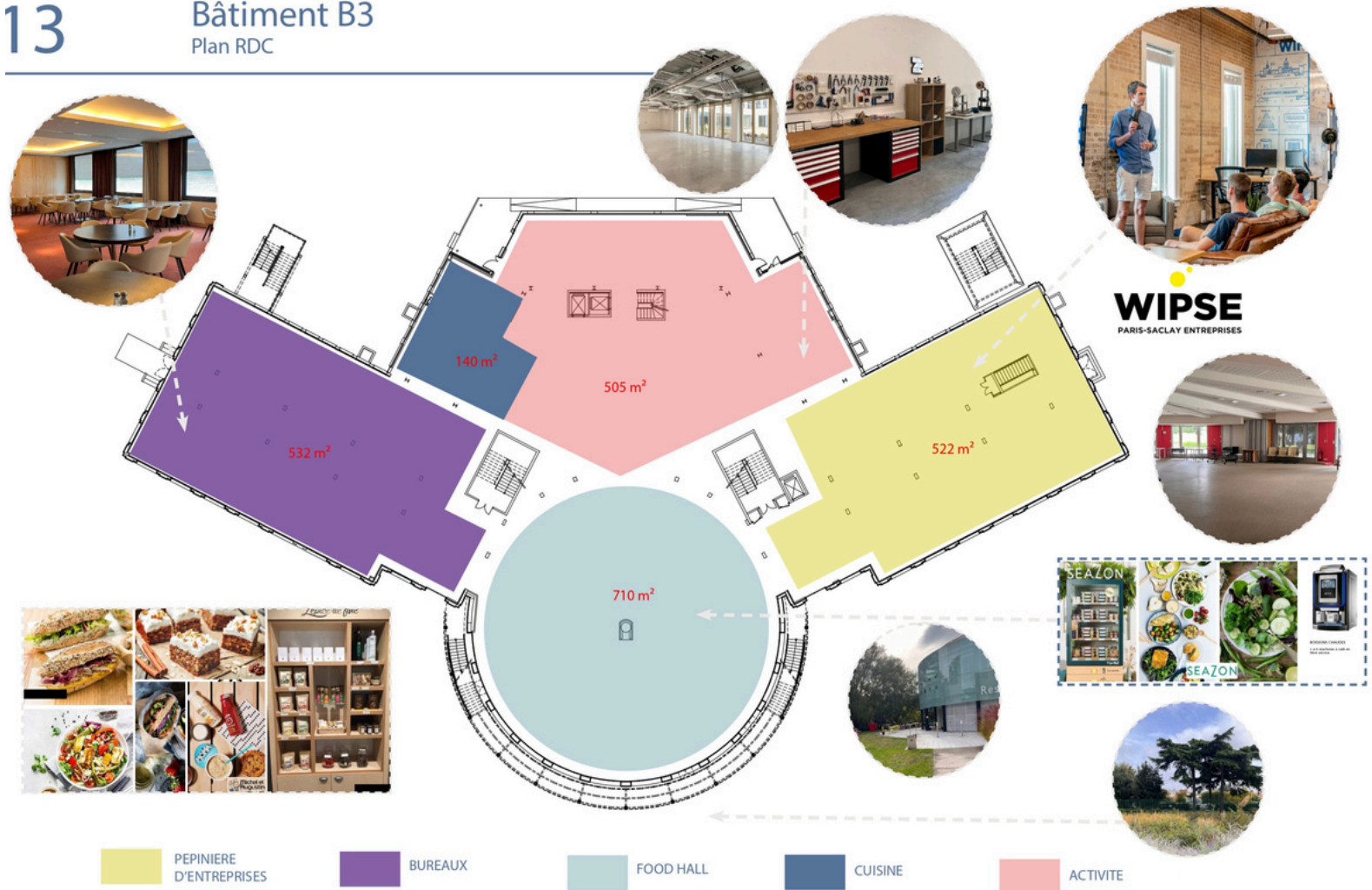

Turnkey projects

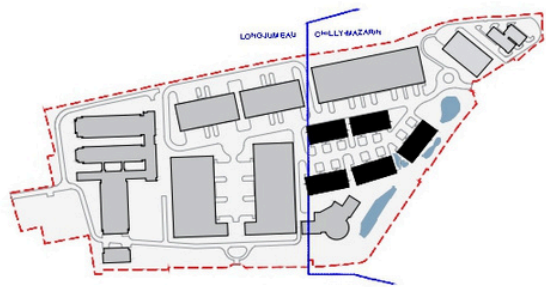

SPECIFICATIONS

- Building height: 10 m
- Ground floor clearance under beam: 7 m
- Ground floor slabs with load resistance of $3T/m^2$
- Mezzanine office spaces of collaborative type
- Inter-unit separation

For production units
or office / R&D /
production units







THANK YOU

Boost

CAMPUS

